

ILLUSTRATED PARTS BREAKDOWN

DEFEB

DECbridge 500/600 Series

ILLUSTRATED PARTS BREAKDOWN (IPB)

The IPB is used to identify a part and its location in a hardware product. The document references specific item numbers in the associated parts list.

HOW TO USE THE IPB

1. Locate the figure containing the item of interest.
2. Locate the number (callout) of the item of interest.
3. Locate that item number in the associated parts list.

FORMAT

Each IPB is generally organized based on its first figure. All other assemblies and subassemblies are referenced from this figure. Each figure contains numeric callouts of all major parts (items).

PARTS LIST

Each parts list contains the following:

Figure and Item No. – Lists the figure number and its referenced numeric callout

Description – Presents the name and a brief description of the item. A single asterisk (*) preceding the description

denotes item is a subassembly to its referenced figure. A double asterisk (**) preceding the description indicates that this item is subordinate to the preceding single asterisk item.

DEC Part No. – Lists the Digital/Vendor part number. The letter in the column heading indicates the current revision level of the Engineering Drawing for the referenced figure.

ECO Cut-In – Lists the top assembly drawing number and revision level at first printing. All additional revisions to an item are listed in this column.

Used On Code – Lists letters referring to the product variation assigned in Figure 1. When this column is blank, the item is used in all options.

Ref Fig No. – Lists a cross reference between figures within the IPB.

PART NUMBER/PART DESCRIPTION INDEX SECTION

Lists items by part number numerically, and description alphabetically. Items are also referenced to a location within the IPB by figure and item number.

ECO/REVISION HISTORY

FIGURE NO.	ASSEMBLY	INITIAL LEVEL	CURRENT LEVEL	PRINTING DATE	OTHER IPB MANUALS REFERENCED
1	DEFEB	00000	00002	23-SEP-91	N/A
1A	70-27396	00000	00001		
2	DEFEB	00002	00002		
2A	70-27396	00001	00001		
3	70-27393	00000	00000		

Digital Equipment Corporation reserves the right, without notice, to make substitutions and modifications in the specifications of products documented in this manual and further reserves the right to withdraw any of these products from the market without notice.

Digital Equipment Corporation is not responsible for errors which may appear in the technical description (including illustrations and photographs) of the products covered by this manual.

None of the descriptions contained in this manual imply the granting of any license whatsoever to make, use or sell equipment constructed in accordance therewith.

Restricted Rights: Use, duplication or disclosure by the U.S. Government is subject to restrictions as set forth in subparagraph (c) (1) (ii) of the Rights in Technical Data and Computer Software clause at DFARS 252.227-2713.

Copyright © 1990, 1991 by Digital Equipment Corporation. All rights reserved.
Printed in U.S.A.

The postage-paid READER'S COMMENTS form on the last page of this document requests your critical evaluation to assist us in preparing future documentation.

The following are trademarks of Digital Equipment Corporation :

DECbridge, DECconnect, DECdirect, DECserver, DEMPA, DESTA, ThinWire and the
"DIGITAL logo."

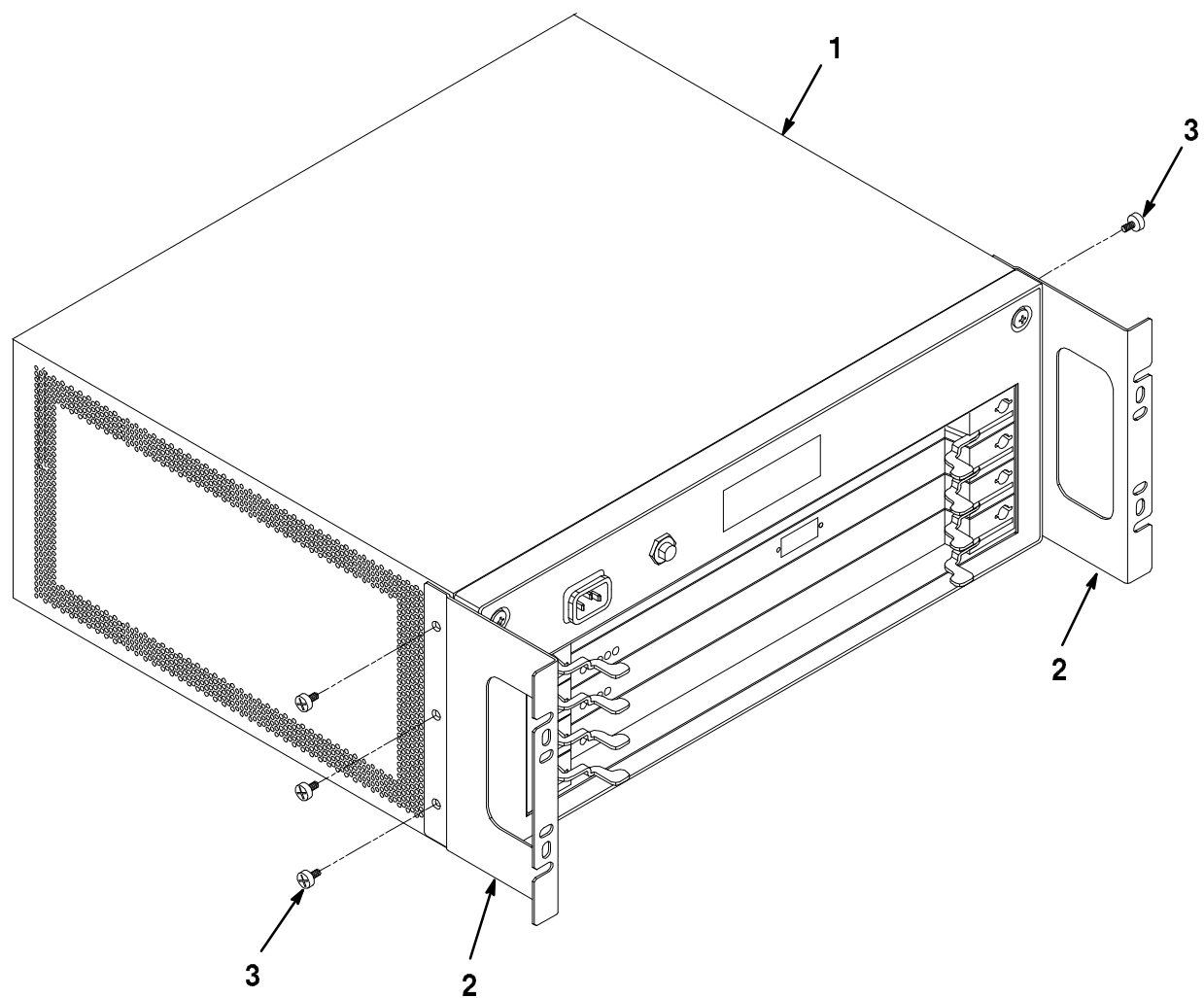

DEFEB-01-IL

Figure 1. DEFEB DECbridge (500 Series)

FIG.& ITEM NO.	DESCRIPTION	DEC PART NO. ^C	ECO CUT-IN DEFEB 00000	USED ON CODE	REF FIG NO.
1-	DEFEB, DECbridge 500 Series				
	Code AA—Used on DEFEB-AA (DECbridge 500) U.S. version, FDDI to 802.3 LAN bridge SAS, standard FDDI optics, one 802.3 port	DEFEB-AA		AA	
	Code AB—Used on DEFEB-AB (DECbridge 500) Non-U.S. version, FDDI to 802.3 LAN bridge, SAS, standard FDDI optics one 802.3 port	DEFEB-AB		AB	
	Code AC—Used on DEFEB-AC (DECbridge 510) U.S. version, FDDI to 802.3 LAN bridge SAS, standard FDDI optics, one 802.3 port (added)	DEFEB-AC	00002	AC	
	Code AD—Used on DEFEB-AD (DECbridge 510) Non-U.S. version, FDDI to 802.3 LAN bridge, SAS, standard FDDI optics one 802.3 port (added)	DEFEB-AD	00002	AD	
	Code AS—Used on DEFEB-AS (DECbridge 518) U.S. version, FDDI to 802.3 LAN bridge SAS, single-mode FDDI optics, one 802.3 port (added)	DEFEB-AS	00002	AS	
	Code AT—Used on DEFEB-AT (DECbridge 518) Non-U.S. version, FDDI to 802.3 LAN bridge, SAS, single-mode FDDI optics, one 802.3 port (added)	DEFEB-AT	00002	AT	
	Code DA—Used on DEFEB-DA (DECbridge 520) U.S. version, FDDI to 802.3 LAN bridge DAS, standard FDDI optics, one 802.3 port (added)	DEFEB-DA	00002	DA	
	Code DB—Used on DEFEB-DB (DECbridge 520) Non-U.S. version, FDDI to 802.3 LAN bridge, DAS, standard FDDI optics ports A and B, one 802.3 port (added)	DEFEB-DB	00002	DB	
	Code DM—Used on DEFEB-DM (DECbridge 524) U.S. version, FDDI to 802.3 LAN bridge one DAS FDDI station, single-mode optics on port A, multi-mode optics port B, one Ethernet/802.3 port (added)	DEFEB-DM	00002	DM	

FIG.& ITEM NO.	DESCRIPTION	DEC PART NO.	ECO CUT-IN DEFEB 00000	USED ON CODE	REF FIG NO.
1-	DEFEB, DECbridge 500 Series (continued)				
	Code DN—Used on DEFEB-DN (DECbridge 524) Non-U.S. version, FDDI to 802.3 LAN bridge, one DAS FDDI station, single-mode optics on port A, multi-mode optics port B, (added) one Ethernet/802.3 port (added)	DEFEB-DN	00002	DN	
	Code DP—Used on DEFEB-DP (DECbridge 526) U.S. version, FDDI to 802.3 LAN bridge one DAS FDDI station, multi-mode optics on port A, single-mode optics port B, one Ethernet/802.3 port (added)	DEFEB-DP	00002	DP	
	Code DQ—Used on DEFEB-DQ (DECbridge 526) Non-U.S. version, FDDI to 802.3 LAN bridge, one DAS FDDI station, multi-mode optics on port A, single- mode optics port B, one Ethernet/ 802.3 port (added)	DEFEB-DQ	00002	DQ	
	Code DS—Used on DEFEB-DS (DECbridge 528) U.S. version, FDDI to 802.3 LAN bridge DAS, single-mode FDDI optics port A and B (added)	DEFEB-DS	00002	DS	
	Code DT—Used on DEFEB-DT (DECbridge 528) Non-U.S. version, FDDI to 802.3 LAN bridge, DAS, single-mode FDDI optics port A and B (added)	DEFEB-DT	00002	DT	
1	*DEFEB UNIT ASSEMBLY (DECbridge 500)	70-27396-01		AA, AB	1A
	*DEFEB UNIT ASSEMBLY (DECbridge 518) (added)	70-27396-02	00002	AS, AT	1A
	*DEFEB UNIT ASSEMBLY (DECbridge 520) (added)	70-27396-03	00002	DA, DB	1A
	*DEFEB UNIT ASSEMBLY (DECbridge 524) (added)	70-27396-04	00002	DM, DN	1A
	*DEFEB UNIT ASSEMBLY (DECbridge 526) (added)	70-27396-05	00002	DP, DQ	1A
	*DEFEB UNIT ASSEMBLY (DECbridge 518) (added)	70-27396-06	00002	DS, DT	1A
	*DEFEB UNIT ASSEMBLY (DECbridge 510) (added)	70-27396-13	00002	AC, AD	1A
2	*Bracket, Rack Mounting	74-39897-01			
3	*Screw, Machine Flat Hd No. 6-32 x 5/16	90-08404-02			

FIG.& ITEM NO.	DESCRIPTION	DEC PART NO. ^C	ECO CUT-IN DEFEB 00000	USED ON CODE	REF FIG NO.
1-	<p>ITEMS (Not Shown)</p> <p>*Connector, BNC Tee Coaxial *Connector, BNC Coaxial 50 Ohms *Connector Assembly, AUI Loopback *Retainer, Clip-On U-Nut No. 10-32 *Screw, Self-Tap Truss Hd No. 10 x 1/2 *Power Cord, Terminal 125V</p> <p>*Connector, Multi-mode Non-Attenuated</p> <p>*Connector, Single-mode Attenuated Loopback (added)</p> <p>UPGRADE KITS (Not Shown)</p> <p>*Kit, DECbridge 500 to 3-NI ports Upgrade (Contains AP2+, 2 AUI Loopback Connector Assembly, NI3 and Documentation Kit)</p> <p>*Kit, SAS to a DAS Upgrade (Contains FI2, 1 FDDI Multi-mode Loopback Connector Assembly, and Documentation Kit)</p>	<p>12-25869-01 12-26318-01 12-22196-01 90-07786-00 90-00063-39 17-00606-02</p> <p>12-32005-01</p> <p>12-34830-01</p> <p>DEFEB-UG</p> <p>DEFEB-UP</p>	<p>00002</p>	<p>AA, AC AS DA, DM DP, DS AA, AB AC, AD DA, DB DM, DN DP, DQ AS, AT DM, DN DP, DQ DS, DT</p>	

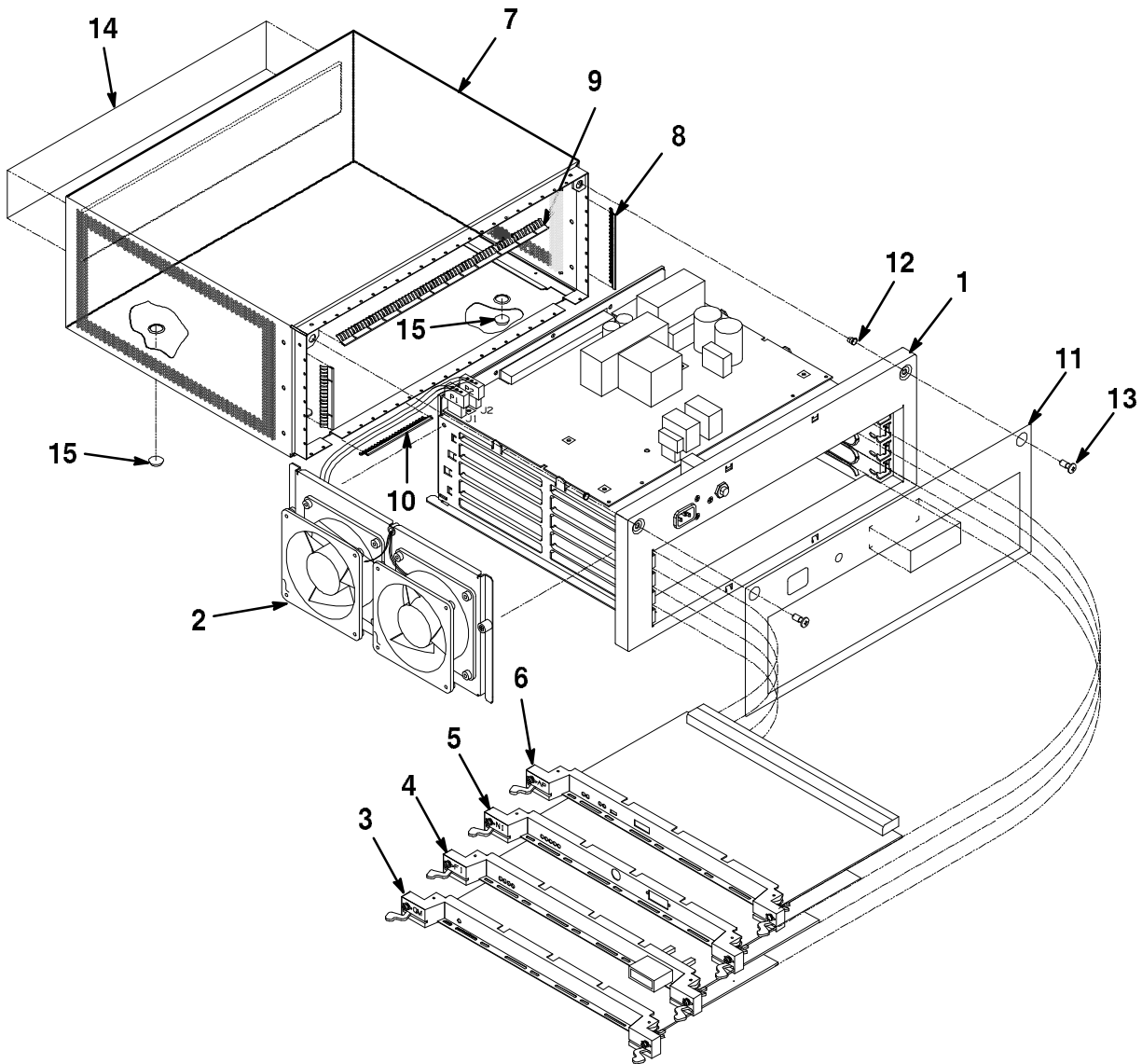

DEFEB-01A-IL

Figure 1A. DEFEB Unit Assembly (500 Series)

FIG.& ITEM NO.	DESCRIPTION	DEC PART NO.	ECO CUT-IN 70-27396 00000	USED ON CODE	REF FIG NO.
1A-	DEFEB UNIT ASSEMBLY (DECbridge 500)	70-27396-01		AA, AB	1
	DEFEB UNIT ASSEMBLY (DECbridge 510)	70-27396-13		AC, AD	1
	DEFEB UNIT ASSEMBLY (DECbridge 518)	70-27396-02		AS, AT	1
	DEFEB UNIT ASSEMBLY (DECbridge 520)	70-27396-03		DA, DB	1
	DEFEB UNIT ASSEMBLY (DECbridge 524)	70-27396-04		DM, DN	1
	DEFEB UNIT ASSEMBLY (DECbridge 526)	70-27396-05		DP, DQ	1
	DEFEB UNIT ASSEMBLY (DECbridge 528)	70-27396-06		DS, DT	1
1	*CARD CAGE/BACKPLANE ASSEMBLY	70-27393-01		AA, AB AC, AD AS, AT DA, DB DM, DN DP, DQ DS, DT	3
2	*FAN BRACKET ASSEMBLY	70-27394-01			
	**Fan, 4 1/2 Inch	12-23609-10			
	**Bracket, Fan	74-39893-01			
	**Screw, Self-Tap Truss Hd No. 6 x 5/8	90-00062-16			
	**Bushing, Strain Relief	12-28936-01			
	**Clip, Cable	12-21249-01			
	**Cable Tie	90-09996-01			
3	*Module, Queue Manager	54-19371-01			
4	*Module, Fiber Interconnect	54-19369-01		AA, AB AC, AD DA, DB	
	*Module, Fiber Interconnect DAS ANSI (added)	54-19369-02	00001	AS, AT	
	*Module, Fiber Interconnect SAS SM (added)	54-19369-03	00001	DP, DQ	
	*Module, Fiber Interconnect DAS ANSI/SM (added)	54-19369-04	00001		
	*Module, Fiber Interconnect DAS SM/ANSI (added)	54-19369-05	00001	DM, DN	
	*Module, Fiber Interconnect DAS SM (added)	54-19369-06	00001	DS, DT	
5	*Module, Network Interconnect	54-19373-01			
6	*Module, Application Processor	54-19375-01		AA, AB AC, AD AS, AT DA, DB DM, DN DP, DQ DS, DT	
	*Module, Application Processor 2 (added)	54-19375-02	00001		

FIG.& ITEM NO.	DESCRIPTION	^B DEC PART NO.	ECO CUT-IN 70-27396 00000	USED ON CODE	REF FIG NO.
1A-					
7	*Enclosure, (Weldment)	70-27395-01			
8	*Fingerstock, w/D-Lance	12-32618-07			
9	*Fingerstock, w/D-Lance	12-32618-21			
10	*Fingerstock, w/D-Lance	12-32618-18			
11	*Label, DEFEB "DECbridge 500" Rear	36-32050-01		AA, AB	
	*Label, DEFEB "Option Numbers" (added)	36-35439-01	00001	AC, AD	
				AS, AT	
				DA, DB	
				DM, DN	
				DP, DQ	
				DS, DT	
	*Label, DEFEB "Option Numbers" (Ireland)	36-35439-02			
12	*Spring, Retaining	12-12972-13			
13	*Fastener, Phl Hd 1/4 Turn	90-10846-01			
14	*Label, DEFEB "DECbridge 500" Front	36-32533-01			
15	*Bumper, Rubber	90-09538-00			

THIS PAGE INTENTIONALLY LEFT BLANK

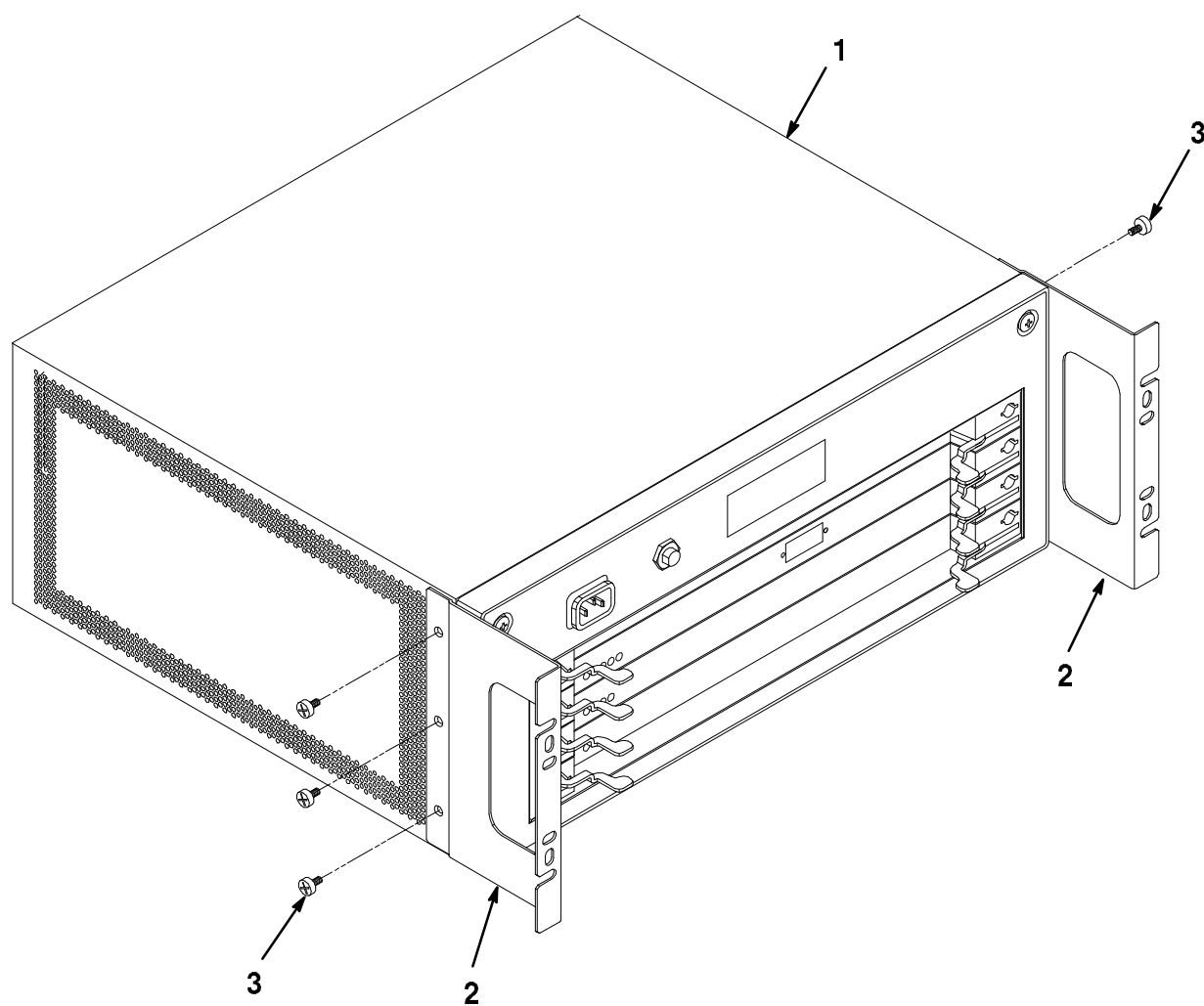

DEFEB-02-IL

Figure 2. DEFEB DECbridge (600 Series)

FIG.& ITEM NO.	DESCRIPTION	DEC PART NO. ^c	ECO CUT-IN DEFEB 00002	USED ON CODE	REF FIG NO.
2-	DEFEB, DECbridge 600 Series				
	Code LA—Used on DEFEB-LA (DECbridge 620) U.S. version, FDDI to 3 port 802.3 LAN bridge, DAS, standard FDDI optics	DEFEB-LA		LA	
	Code LB—Used on DEFEB-LB (DECbridge 620) Non-U.S. version, FDDI to 3 port 802.3 LAN bridge, DAS, standard FDDI optics	DEFEB-LB		LB	
	Code LM—Used on DEFEB-LM (DECbridge 624) U.S. version, FDDI to 802.3 LAN bridge one DAS FDDI station, single-mode optics on port A, multi-mode optics port B, three Ethernet/802.3 port.	DEFEB-LM		LM	
	Code LN—Used on DEFEB-LN (DECbridge 624) Non-U.S. version, FDDI to 802.3 LAN bridge, one DAS FDDI station, single-mode optics on port A, multi-mode optics port B, three Ethernet/802.3 port.	DEFEB-LN		LN	
	Code LP—Used on DEFEB-LP (DECbridge 626) U.S. version, FDDI to 802.3 LAN bridge one DAS FDDI station, multi-mode optics on port A, single-mode optics port B, three Ethernet/802.3 port.	DEFEB-LP		LP	
	Code LQ—Used on DEFEB-LQ (DECbridge 626) Non-U.S. version, FDDI to 802.3 LAN bridge, one DAS FDDI station, multi-mode optics on port A, single-mode optics port B, three Ethernet/802.3 port.	DEFEB-LQ		LQ	
	Code LS—Used on DEFEB-LS (DECbridge 628) U.S. version, FDDI to 3 port 802.3 LAN bridge, DAS, single-mode FDDI optics port A and B.	DEFEB-LS		LS	
	Code LT—Used on DEFEB-LT (DECbridge 628) Non-U.S. version, FDDI to 3 port 802.3 LAN bridge, DAS, single-mode FDDI optics port A and B.	DEFEB-LT		LT	
	Code NC—Used on DEFEB-NC (DECbridge 600) U.S. version, 3 port 802.3 LAN bridge.	DEFEB-NC		NC	
	Code ND—Used on DEFEB-ND (DECbridge 600) Non-U.S. version, FDDI to 3 port 802.3 LAN bridge, SAS, standard FDDI optics	DEFEB-ND		ND	
	Code TA—Used on DEFEB-TA (DECbridge 610) U.S. version, FDDI to 3 port 802.3 LAN bridge, SAS, standard FDDI optics.	DEFEB-TA		TA	

FIG.& ITEM NO.	DESCRIPTION	DEC PART NO. ^C	ECO CUT-IN DEFEB 00002	USED ON CODE	REF FIG NO.
2-	DEFEB, DECbridge 600 Series (continued)				
	Code TB—Used on DEFEB-TB (DECbridge 610) Non-U.S. version, FDDI to 3 port 802.3 LAN bridge, SAS, standard FDDI optics	DEFEB-TB		TB	
	Code TS—Used on DEFEB-TS (DECbridge 618) U.S. version, FDDI to 3 port 802.3 LAN bridge, SAS, single-mode FDDI optics	DEFEB-TS		TS	
	Code TT—Used on DEFEB-TT (DECbridge 618) Non-U.S. version, FDDI to 3 port 802.3 LAN bridge, SAS, single-mode FDDI optics	DEFEB-TT		TT	
1	*DEFEB UNIT ASSEMBLY (DECbridge 610)	70-27396-07		TA, TB	2A
	*DEFEB UNIT ASSEMBLY (DECbridge 618)	70-27396-08		TS, TT	2A
	*DEFEB UNIT ASSEMBLY (DECbridge 620)	70-27396-09		LA, LB	2A
	*DEFEB UNIT ASSEMBLY (DECbridge 624)	70-27396-10		LM, LN	2A
	*DEFEB UNIT ASSEMBLY (DECbridge 626)	70-27396-11		LP, LQ	2A
	*DEFEB UNIT ASSEMBLY (DECbridge 628)	70-27396-12		LS, LT	2A
	*DEFEB UNIT ASSEMBLY (DECbridge 600)	70-27396-14		NC, ND	2A
2	*Bracket, Rack Mounting	74-39897-01			
3	*Screw, Machine Flat Hd No. 6-32 x 5/16	90-08404-02			
	ITEMS (Not Shown)				
	*Connector Assembly, AUI Loopback	12-22196-01			
	*Retainer, Clip-On U-Nut No. 10-32	90-07786-00			
	*Screw, Self-Tap Truss Hd No. 10 x 1/2	90-00063-39			
	*Power Cord, Terminal 125V	17-00606-02		LA, LM LP, LS NC, TA TS	
	*Connector, Multi-mode Non-Attenuated	12-32005-01		LA, LB LM, LN LP, LQ TA, TB	
	*Connector, Single-mode Attenuated Loopback	12-34830-01		LM, LN LP, LQ LS, LT TS, TT	

THIS PAGE INTENTIONALLY LEFT BLANK

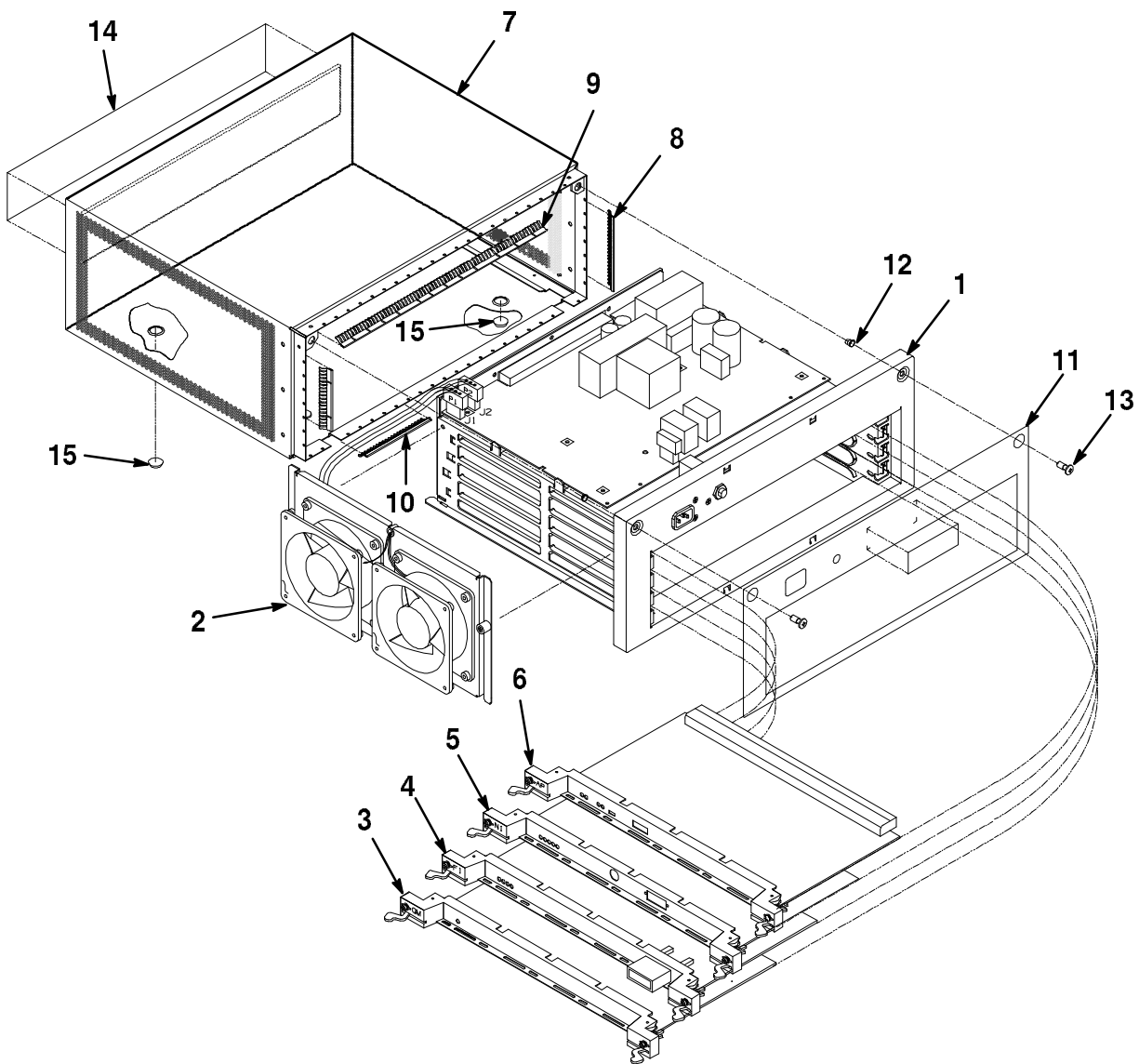

DEFEB-02A-IL

Figure 2A. DEFEB Unit Assembly (600 Series)

FIG.& ITEM NO.	DESCRIPTION	^B DEC PART NO.	ECO CUT-IN 70-27396 00001	USED ON CODE	REF FIG NO.
2A-	DEFEB UNIT ASSEMBLY (DECbridge 620)	70-27396-09		LA, LB	2
	DEFEB UNIT ASSEMBLY (DECbridge 624)	70-27396-10		LM, LN	2
	DEFEB UNIT ASSEMBLY (DECbridge 626)	70-27396-11		LP, LQ	2
	DEFEB UNIT ASSEMBLY (DECbridge 628)	70-27396-12		LS, LT	2
	DEFEB UNIT ASSEMBLY (DECbridge 600)	70-27396-14		NC, ND	2
	DEFEB UNIT ASSEMBLY (DECbridge 610)	70-27396-07		TA, TB	2
	DEFEB UNIT ASSEMBLY (DECbridge 618)	70-27396-08		TS, TT	2
1	*CARD CAGE/BACKPLANE ASSEMBLY	70-27393-01			3
2	*FAN BRACKET ASSEMBLY	70-27394-01			
	**Fan, 4 1/2 Inch	12-23609-10			
	**Bracket, Fan	74-39893-01			
	**Screw, Self-Tap Truss Hd No. 6 x 5/8	90-00062-16			
	**Bushing, Strain Relief	12-28936-01			
	**Clip, Cable	12-21249-01			
	**Cable Tie	90-09996-01			
3	*Module, Queue Manager	54-19371-01			
4	*Module, Fiber Interconnect	54-19369-01		TA, TB	
	*Module, Fiber Interconnect DAS ANSI	54-19369-02		LA, LB	
	*Module, Fiber Interconnect SAS SM	54-19369-03		TS, TT	
	*Module, Fiber Interconnect DAS ANSI/SM	54-19369-04		LP, LQ	
	*Module, Fiber Interconnect DAS SM/ANSI	54-19369-05		LM, LN	
	*Module, Fiber Interconnect DAS SM	54-19369-06		LS, LT	
	*Module, Fiber Interconnect Null	54-19369-09		NC, ND	
5	*Module, Multiport NI	54-19409-01		NC, ND	
6	*Module, Application Processor 2	54-19375-02			
7	*Enclosure, (Weldment)	70-27395-01			
8	*Fingerstock, w/D-Lance	12-32618-07			
9	*Fingerstock, w/D-Lance	12-32618-21			
10	*Fingerstock, w/D-Lance	12-32618-18			
11	*Label, DEFEB "Option Numbers"	36-35439-01			
	*Label, DEFEB "Option Numbers" (Ireland)	36-35439-02			
12	*Spring, Retaining	12-12972-13			
13	*Fastener, Phl Hd 1/4 Turn	90-10846-01			
14	*Label, DEFEB "DECbridge 600" Front	36-32533-02			
15	*Bumper, Rubber	90-09538-00			

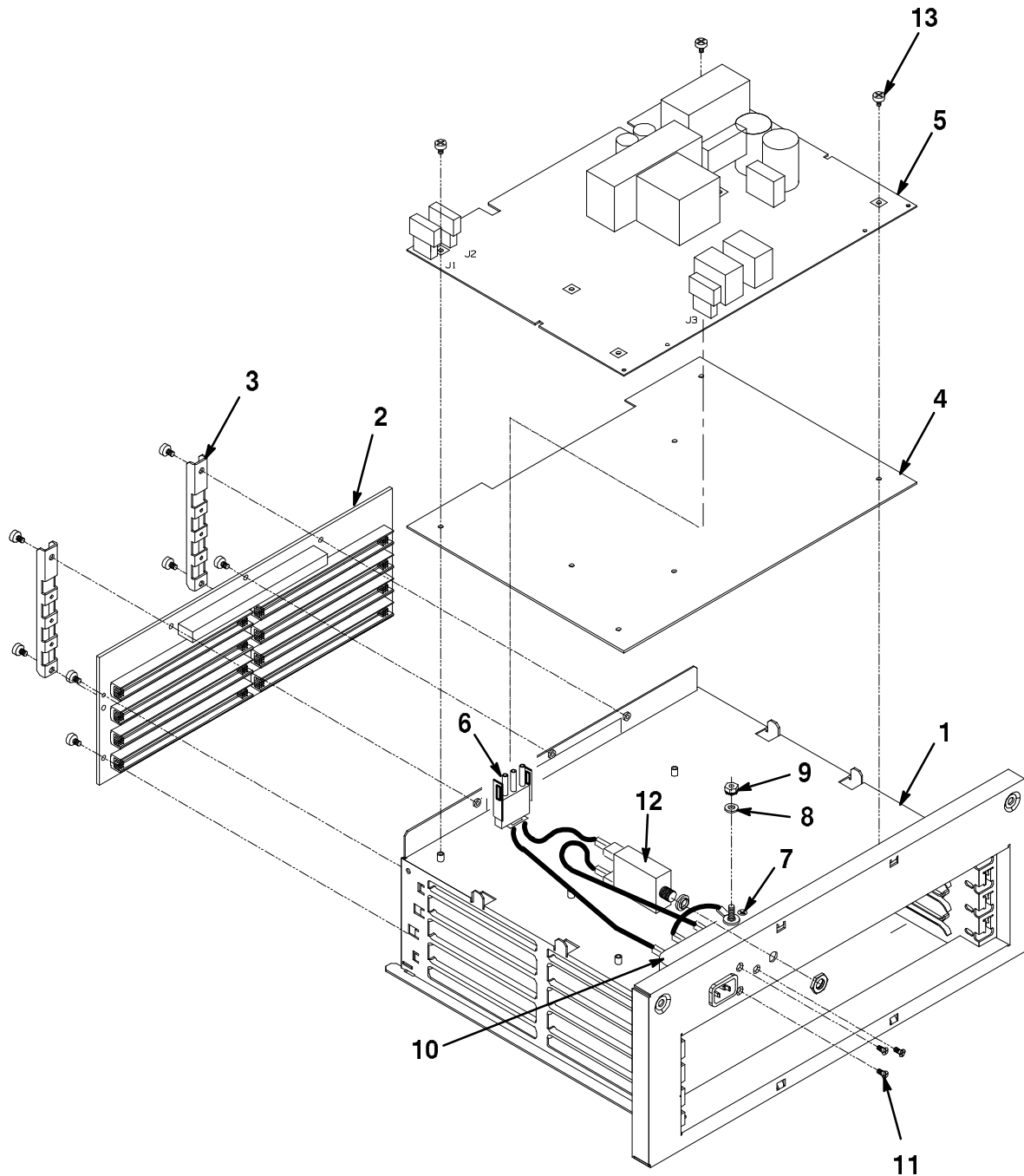

DEFEB-03-IL

Figure 3. DEFEB Card Cage/Backplane Assembly

FIG.& ITEM NO.	DESCRIPTION	DEC PART NO.	ECO CUT-IN 70-27393 00000	USED ON CODE	REF FIG NO.
3-	DEFEB CARD CAGE/BACKPLANE ASSEMBLY	70-27393-01			1A, 2A
1	*Card Cage, (Weldment)	70-27397-01			
2	*Backplane	54-19377-01			
3	*Stiffener, Backplane	74-39892-01			
4	*Insulator, Power Supply	74-39898-01			
5	*Power Supply, Switching 370W	30-32524-01			
6	*Input Assembly, A.C.	70-27416-01			
7	*Label, Ground Symbol	36-12680-02			
8	*Washer, Flat	90-06664-00			
9	*Nut, Kep No. 10-32 x 3/8	90-06565-00			
10	*Filter, Line EMI 1PH 120V/240V 6/4A	12-32904-01			
11	*Screw, Machine Phl Flat Hd No. 6-32 x 5/16	90-08404-02			
12	*Breaker, Circuit 1P 7.5A 250V	12-19912-06			
13	*Screw, Self-Tap Truss Hd No. 6-32 x 3/8	90-00063-11			
					Ω

PART NUMBER/DESCRIPTION INDEX

INDEX BY DEC PART NUMBER
DEFEB DECbridge 500/600 Series

PART NO.	DESCRIPTION	FIG NO.	ITEM NO.
12-12972-13	Spring, Retaining	1A	12
12-12972-13	Spring, Retaining	2A	12
12-19912-06	Breaker, Circuit 1P 7.5A 250V	3	12
12-21249-01	Clip, Cable	2A	2
12-21249-01	Clip, Cable	1A	2
12-22196-01	Connector Assembly, AUI Loopback	1	Not Shown
12-22196-01	Connector Assembly, AUI Loopback	2	Not Shown
12-23609-10	Fan, 4 1/2 Inch	1A	2
12-23609-10	Fan, 4 1/2 Inch	2A	2
12-25869-01	Connector, BNC Tee Coaxial	1	Not Shown
12-26318-01	Connector, BNC Coaxial 50 Ohms	1	Not Shown
12-28936-01	Bushing, Strain Relief	1A	2
12-28936-01	Bushing, Strain Relief	2A	2
12-32005-01	Connector, Multi-mode Non-Attenuated	1	Not Shown
12-32005-01	Connector, Multi-mode Non-Attenuated	2	Not Shown
12-32618-07	Fingerstock, w/D-Lance	2A	8
12-32618-07	Fingerstock, w/D-Lance	1A	8
12-32618-18	Fingerstock, w/D-Lance	1A	10
12-32618-18	Fingerstock, w/D-Lance	2A	10
12-32618-21	Fingerstock, w/D-Lance	2A	9
12-32618-21	Fingerstock, w/D-Lance	1A	9
12-32904-01	Filter, Line EMI 1PH 120V/240V 6/4A	3	10
12-34830-01	Connector, Single-mode Attenuated Loopback	2	Not Shown
12-34830-01	Connector, Single-mode Attenuated Loopback	1	Not Shown
17-00606-02	Power Cord, Terminal 125V	2	Not Shown
17-00606-02	Power Cord, Terminal 125V	1	Not Shown
30-32524-01	Power Supply, Switching 370W	3	5
36-12680-02	Label, Ground Symbol	3	7
36-32050-01	Label, DEFEB "DECbridge 500" Rear	1A	11
36-32533-01	Label, DEFEB "DECbridge 500" Front	1A	14
36-32533-02	Label, DEFEB "DECbridge 600" Front	2A	14
36-35439-01	Label, DEFEB "Option Numbers" (added)	1A	11
36-35439-01	Label, DEFEB "Option Numbers"	2A	11
36-35439-02	Label, DEFEB "Option Numbers" (Ireland)	1A	11
36-35439-02	Label, DEFEB "Option Numbers" (Ireland)	2A	11
54-19369-01	Module, Fiber Interconnect	1A	4
54-19369-01	Module, Fiber Interconnect	2A	4
54-19369-02	Module, Fiber Interconnect DAS ANSI	2A	4
54-19369-02	Module, Fiber Interconnect DAS ANSI (added)	1A	4
54-19369-03	Module, Fiber Interconnect SAS SM (added)	1A	4
54-19369-03	Module, Fiber Interconnect SAS SM	2A	4
54-19369-04	Module, Fiber Interconnect DAS ANSI/SM	2A	4
54-19369-04	Module, Fiber Interconnect DAS ANSI/SM (added)	1A	4
54-19369-05	Module, Fiber Interconnect DAS SM/ANSI	2A	4
54-19369-05	Module, Fiber Interconnect DAS SM/ANSI (added)	1A	4
54-19369-06	Module, Fiber Interconnect DAS SM (added)	1A	4
54-19369-06	Module, Fiber Interconnect DAS SM	2A	4
54-19369-09	Module, Fiber Interconnect Null	2A	4
54-19371-01	Module, Queue Manager	2A	3
54-19371-01	Module, Queue Manager	1A	3
54-19373-01	Module, Network Interconnect	1A	5
54-19375-01	Module, Application Processor	1A	6
54-19375-02	Module, Application Processor 2 (added)	1A	6

INDEX BY DEC PART NUMBER

DEFEB DECbridge 500/600 Series

PART NO.	DESCRIPTION	FIG NO.	ITEM NO.
54-19375-02	Module, Application Processor 2	2A	6
54-19377-01	Backplane	3	2
54-19409-01	Module, Multiport NI	2A	5
70-27393-01	DEFEB CARD CAGE/BACKPLANE ASSEMBLY	3	N/A
70-27393-01	CARD CAGE/BACKPLANE ASSEMBLY	2A	1
70-27393-01	CARD CAGE/BACKPLANE ASSEMBLY	1A	1
70-27394-01	FAN BRACKET ASSEMBLY	2A	2
70-27394-01	FAN BRACKET ASSEMBLY	1A	2
70-27395-01	Enclosure, (Weldment)	1A	7
70-27395-01	Enclosure, (Weldment)	2A	7
70-27396-01	DEFEB UNIT ASSEMBLY (DECbridge 500)	1A	N/A
70-27396-01	DEFEB UNIT ASSEMBLY (DECbridge 500)	1	1
70-27396-02	DEFEB UNIT ASSEMBLY (DECbridge 518) (added)	1	1
70-27396-02	DEFEB UNIT ASSEMBLY (DECbridge 518)	1A	N/A
70-27396-03	DEFEB UNIT ASSEMBLY (DECbridge 520)	1A	N/A
70-27396-03	DEFEB UNIT ASSEMBLY (DECbridge 520) (added)	1	1
70-27396-04	DEFEB UNIT ASSEMBLY (DECbridge 524)	1A	N/A
70-27396-04	DEFEB UNIT ASSEMBLY (DECbridge 524) (added)	1	1
70-27396-05	DEFEB UNIT ASSEMBLY (DECbridge 526) (added)	1	1
70-27396-05	DEFEB UNIT ASSEMBLY (DECbridge 526)	1A	N/A
70-27396-06	DEFEB UNIT ASSEMBLY (DECbridge 528)	1A	N/A
70-27396-06	DEFEB UNIT ASSEMBLY (DECbridge 518) (added)	1	1
70-27396-07	DEFEB UNIT ASSEMBLY (DECbridge 610)	2A	N/A
70-27396-07	DEFEB UNIT ASSEMBLY (DECbridge 610)	2	1
70-27396-08	DEFEB UNIT ASSEMBLY (DECbridge 618)	2A	N/A
70-27396-08	DEFEB UNIT ASSEMBLY (DECbridge 618)	2	1
70-27396-09	DEFEB UNIT ASSEMBLY (DECbridge 620)	2A	N/A
70-27396-09	DEFEB UNIT ASSEMBLY (DECbridge 620)	2	1
70-27396-10	DEFEB UNIT ASSEMBLY (DECbridge 624)	2A	N/A
70-27396-10	DEFEB UNIT ASSEMBLY (DECbridge 624)	2	1
70-27396-11	DEFEB UNIT ASSEMBLY (DECbridge 626)	2	1
70-27396-11	DEFEB UNIT ASSEMBLY (DECbridge 626)	2A	N/A
70-27396-12	DEFEB UNIT ASSEMBLY (DECbridge 628)	2A	N/A
70-27396-12	DEFEB UNIT ASSEMBLY (DECbridge 628)	2	1
70-27396-13	DEFEB UNIT ASSEMBLY (DECbridge 510)	1A	N/A
70-27396-13	DEFEB UNIT ASSEMBLY (DECbridge 510) (added)	1	1
70-27396-14	DEFEB UNIT ASSEMBLY (DECbridge 600)	2A	N/A
70-27396-14	DEFEB UNIT ASSEMBLY (DECbridge 600)	2	1
70-27397-01	Card Cage, (Weldment)	3	1
70-27416-01	Input Assembly, A.C.	3	6
74-39892-01	Stiffener, Backplane	3	3
74-39893-01	Bracket, Fan	2A	2
74-39893-01	Bracket, Fan	1A	2
74-39897-01	Bracket, Rack Mounting	2	2
74-39897-01	Bracket, Rack Mounting	1	2
74-39898-01	Insulator, Power Supply	3	4
90-00062-16	Screw, Self-Tap Truss Hd No. 6 x 5/8	1A	2
90-00062-16	Screw, Self-Tap Truss Hd No. 6 x 5/8	2A	2
90-00063-11	Screw, Self-Tap Truss Hd No. 6-32 x 3/8	3	13
90-00063-39	Screw, Self-Tap Truss Hd No. 10 x 1/2	2	Not Shown
90-00063-39	Screw, Self-Tap Truss Hd No. 10 x 1/2	1	Not Shown
90-06565-00	Nut, Kep No. 10-32 x 3/8	3	9
90-06664-00	Washer, Flat	3	8

INDEX BY DEC PART NUMBER

DEFEB DECbridge 500/600 Series

PART NO.	DESCRIPTION	FIG NO.	ITEM NO.
90-07786-00	Retainer, Clip-On U-Nut No. 10-32	1	Not Shown
90-07786-00	Retainer, Clip-On U-Nut No. 10-32	2	Not Shown
90-08404-02	Screw, Machine Flat Hd No. 6-32 x 5/16	2	3
90-08404-02	Screw, Machine Flat Hd No. 6-32 x 5/16	1	3
90-08404-02	Screw, Machine Phl Flat Hd No. 6-32 x 5/16	3	11
90-09538-00	Bumper, Rubber	2A	15
90-09538-00	Bumper, Rubber	1A	15
90-09996-01	Cable Tie	1A	2
90-09996-01	Cable Tie	2A	2
90-10846-01	Fastener, Phl Hd 1/4 Turn	1A	13
90-10846-01	Fastener, Phl Hd 1/4 Turn	2A	13
DEFEB-AA	DEFEB-AA (DECbridge 500) U.S. version, FDDI to 802.3 LAN bridge SAS, standard FDDI optics, one 802.3 port	1	N/A
DEFEB-AB	DEFEB-AB (DECbridge 500) Non-U.S. version, FDDI to 802.3 LAN bridge SAS, standard FDDI optics, one 802.3 port	1	N/A
DEFEB-AC	DEFEB-AC (DECbridge 510) U.S. version, FDDI to 802.3 LAN bridge SAS, standard FDDI optics, one 802.3 port (added)	1	N/A
DEFEB-AD	DEFEB-AD (DECbridge 510) Non-U.S. version, FDDI to 802.3 LAN bridge, SAS, standard FDDI optics, one 802.3 port (added)	1	N/A
DEFEB-AS	DEFEB-AS (DECbridge 518) U.S. version, FDDI to 802.3 LAN bridge SAS, single-mode FDDI optics, one 802.3 port (added)	1	N/A
DEFEB-AT	DEFEB-AT (DECbridge 518) Non-U.S. version, FDDI to 802.3 LAN bridge, SAS, single-mode FDDI optics, one 802.3 port (added)	1	N/A
DEFEB-DA	DEFEB-DA (DECbridge 520) U.S. version, FDDI to 802.3 LAN bridge DAS, standard FDDI optics, one 802.3 port (added)	1	N/A
DEFEB-DB	DEFEB-DB (DECbridge 520) LAN bridge, Non-U.S. version, FDDI to 802.3 DAS, standard FDDI optics ports A and B, one 802.3 port (added)	1	N/A
DEFEB-DM	DEFEB-DM (DECbridge 524) U.S. version, FDDI to 802.3 LAN bridge one DAS FDDI station, single-mode optics on port A, multi-mode optics port B, one Ethernet/802.3 port (added)	1	N/A
DEFEB-DN	DEFEB-DN (DECbridge 524) Non-U.S. version, FDDI to 802.3 LAN bridge, one DAS FDDI station, single-mode optics on port A, multi-mode optics port B, one Ethernet/802.3 port (added)	1	N/A
DEFEB-DP	DEFEB-DP (DECbridge 526) U.S. version, FDDI to 802.3 LAN bridge one DAS FDDI station, multi-mode optics on port A, single-mode optics port B, one Ethernet/802.3 port (added)	1	N/A
DEFEB-DQ	DEFEB-DQ (DECbridge 526) Non-U.S. version, FDDI to 802.3 LAN bridge, one DAS FDDI station, multi-mode optics on port A, single-mode optics port B, one Ethernet/802.3 port (added)	1	N/A

INDEX BY DEC PART NUMBER
DEFEB DECbridge 500/600 Series

PART NO.	DESCRIPTION	FIG NO.	ITEM NO.
DEFEB-DS	DEFEB-DS (DECbridge 528) U.S. version, FDDI to 802.3 LAN bridge DAS, single-mode FDDI optics port A and B (added)	1	N/A
DEFEB-DT	DEFEB-DT (DECbridge 528) Non-U.S. version, FDDI to 802.3 LAN bridge, DAS, single-mode FDDI optics port A and B (added)	1	N/A
DEFEB-LA	DEFEB-LA (DECbridge 620) U.S. version, FDDI to 3 port 802.3 LAN bridge, DAS, standard FDDI optics	2	N/A
DEFEB-LB	DEFEB-LB (DECbridge 620) Non-U.S. version, FDDI to 3 port 802.3 LAN bridge, DAS, standard FDDI optics	2	N/A
DEFEB-LM	DEFEB-LM (DECbridge 624) U.S. version, FDDI to 802.3 LAN bridge one DAS FDDI station, single-mode optics on port A, multi-mode optics port B, three Ethernet/802.3 port	2	N/A
DEFEB-LN	DEFEB-LN (DECbridge 624) Non-U.S. version, FDDI to 802.3 LAN bridge, one DAS FDDI station, single-mode optics on port A, multi-mode optics port B, three Ethernet/802.3 port	2	N/A
DEFEB-LP	DEFEB-LP (DECbridge 626) U.S. version, FDDI to 802.3 LAN bridge one DAS FDDI station, multi-mode optics on port A, single-mode optics port B, three Ethernet/802.3 port	2	N/A
DEFEB-LQ	DEFEB-LQ (DECbridge 626) Non-U.S. version, FDDI to 802.3 LAN bridge, one DAS FDDI station, multi-mode optics on port A, single-mode optics port B, three Ethernet/802.3 port	2	N/A
DEFEB-LS	DEFEB-LS (DECbridge 628) U.S. version, FDDI to 3 port 802.3 LAN bridge, DAS, single-mode FDDI optics port A and B	2	N/A
DEFEB-LT	DEFEB-LT (DECbridge 628) Non-U.S. version, FDDI to 3 port 802.3 LAN bridge, DAS, single-mode FDDI optics port A and B	2	N/A
DEFEB-NC	DEFEB-NC (DECbridge 600) U.S. version, 3 port 802.3 LAN bridge	2	N/A
DEFEB-ND	DEFEB-ND (DECbridge 600) Non-U.S. version, FDDI to 3 port 802.3 LAN bridge, SAS, standard FDDI optics	2	N/A
DEFEB-TA	DEFEB-TA (DECbridge 610) U.S. version, FDDI to 3 port 802.3 LAN bridge, SAS, standard FDDI optics	2	N/A
DEFEB-TB	DEFEB-TB (DECbridge 610) Non-U.S. version, FDDI to 3 port 802.3 LAN bridge, SAS, standard FDDI optics	2	N/A
DEFEB-TS	DEFEB-TS (DECbridge 618) U.S. version, FDDI to 3 port 802.3 LAN bridge, SAS, single-mode FDDI optics	2	N/A
DEFEB-TT	DEFEB-TT (DECbridge 618) Non-U.S. version, FDDI to 3 port 802.3 LAN bridge, SAS, single-mode FDDI optics	2	N/A
DEFEB-UG	Kit, DECbridge 500 to 3-NI ports Upgrade (Contains AP2+, 2 AUI Loopback Connector Assembly, NI3 and Documentation Kit)	1	Not Shown
DEFEB-UP	Kit, SAS to a DAS Upgrade (Contains FI2, 1 FDDI Multi-mode Loopback Connector Assembly, and Documentation Kit)	1	Not Shown

INDEX BY DEC PART DESCRIPTION

DEFEB DECbridge 500/600 Series

DESCRIPTION	DEC PART NO.	FIG. NO.	ITEM NO.
Backplane	54-19377-01	3	2
Bracket, Fan	74-39893-01	2A	2
Bracket, Fan	74-39893-01	1A	2
Bracket, Rack Mounting	74-39897-01	2	2
Bracket, Rack Mounting	74-39897-01	1	2
Breaker, Circuit 1P 7.5A 250V	12-19912-06	3	12
Bumper, Rubber	90-09538-00	2A	15
Bumper, Rubber	90-09538-00	1A	15
Bushing, Strain Relief	12-28936-01	1A	2
Bushing, Strain Relief	12-28936-01	2A	2
Cable Tie	90-09996-01	2A	2
Cable Tie	90-09996-01	1A	2
Card Cage, (Weldment)	70-27397-01	3	1
CARD CAGE/BACKPLANE ASSEMBLY	70-27393-01	1A	1
CARD CAGE/BACKPLANE ASSEMBLY	70-27393-01	2A	1
Clip, Cable	12-21249-01	2A	2
Clip, Cable	12-21249-01	1A	2
Connector Assembly, AUI Loopback	12-22196-01	2	Not Shown
Connector Assembly, AUI Loopback	12-22196-01	1	Not Shown
Connector, BNC Coaxial 50 Ohms	12-26318-01	1	Not Shown
Connector, BNC Tee Coaxial	12-25869-01	1	Not Shown
Connector, Multi-mode Non-Attenuated	12-32005-01	1	Not Shown
Connector, Multi-mode Non-Attenuated	12-32005-01	2	Not Shown
Connector, Single-mode Attenuated Loopback	12-34830-01	2	Not Shown
Connector, Single-mode Attenuated Loopback	12-34830-01	1	Not Shown
DEFEB CARD CAGE/BACKPLANE ASSEMBLY	70-27393-01	3	N/A
DEFEB UNIT ASSEMBLY (DECbridge 500)	70-27396-01	1	1
DEFEB UNIT ASSEMBLY (DECbridge 500)	70-27396-01	1A	N/A
DEFEB UNIT ASSEMBLY (DECbridge 510)	70-27396-13	1A	N/A
DEFEB UNIT ASSEMBLY (DECbridge 510) (added)	70-27396-13	1	1
DEFEB UNIT ASSEMBLY (DECbridge 518)	70-27396-02	1A	N/A
DEFEB UNIT ASSEMBLY (DECbridge 518) (added)	70-27396-02	1	1
DEFEB UNIT ASSEMBLY (DECbridge 518) (added)	70-27396-06	1	1
DEFEB UNIT ASSEMBLY (DECbridge 520)	70-27396-03	1A	N/A
DEFEB UNIT ASSEMBLY (DECbridge 520) (added)	70-27396-03	1	1
DEFEB UNIT ASSEMBLY (DECbridge 524)	70-27396-04	1A	N/A
DEFEB UNIT ASSEMBLY (DECbridge 524) (added)	70-27396-04	1	1
DEFEB UNIT ASSEMBLY (DECbridge 526)	70-27396-05	1A	N/A
DEFEB UNIT ASSEMBLY (DECbridge 526) (added)	70-27396-05	1	1
DEFEB UNIT ASSEMBLY (DECbridge 528)	70-27396-06	1A	N/A
DEFEB UNIT ASSEMBLY (DECbridge 600)	70-27396-14	2A	N/A
DEFEB UNIT ASSEMBLY (DECbridge 600)	70-27396-14	2	1
DEFEB UNIT ASSEMBLY (DECbridge 610)	70-27396-07	2A	N/A
DEFEB UNIT ASSEMBLY (DECbridge 610)	70-27396-07	2	1
DEFEB UNIT ASSEMBLY (DECbridge 618)	70-27396-08	2	1
DEFEB UNIT ASSEMBLY (DECbridge 618)	70-27396-08	2A	N/A
DEFEB UNIT ASSEMBLY (DECbridge 620)	70-27396-09	2	1
DEFEB UNIT ASSEMBLY (DECbridge 620)	70-27396-09	2A	N/A
DEFEB UNIT ASSEMBLY (DECbridge 624)	70-27396-10	2A	N/A
DEFEB UNIT ASSEMBLY (DECbridge 624)	70-27396-10	2	1
DEFEB UNIT ASSEMBLY (DECbridge 626)	70-27396-11	2	1
DEFEB UNIT ASSEMBLY (DECbridge 626)	70-27396-11	2A	N/A

INDEX BY DEC PART DESCRIPTION

DEFEB DECbridge 500/600 Series

DESCRIPTION	DEC PART NO.	FIG. NO.	ITEM NO.
DEFEB UNIT ASSEMBLY (DECbridge 628)	70-27396-12	2A	N/A
DEFEB UNIT ASSEMBLY (DECbridge 628)	70-27396-12	2	1
DEFEB, DECbridge 500 Series	N/A	1	N/A
DEFEB, DECbridge 600 Series	N/A	2	N/A
DEFEB-AA (DECbridge 500) U.S. version, FDDI to 802.3 LAN bridge SAS, standard FDDI optics, one 802.3 port	DEFEB-AA	1	N/A
DEFEB-AB (DECbridge 500) Non-U.S. version, FDDI to 802.3 LAN bridge SAS, standard FDDI optics, one 802.3 port	DEFEB-AB	1	N/A
DEFEB-AC (DECbridge 510) U.S. version, FDDI to 802.3 LAN bridge SAS, standard FDDI optics, one 802.3 port (added)	DEFEB-AC	1	N/A
DEFEB-AD (DECbridge 510) Non-U.S. version, FDDI to 802.3 LAN bridge, SAS, standard FDDI optics, one 802.3 port (added)	DEFEB-AD	1	N/A
DEFEB-AS (DECbridge 518) U.S. version, FDDI to 802.3 LAN bridge SAS, single-mode FDDI optics, one 802.3 port (added)	DEFEB-AS	1	N/A
DEFEB-AT (DECbridge 518) Non-U.S. version, FDDI to 802.3 LAN bridge, SAS, single-mode FDDI optics, one 802.3 port (added)	DEFEB-AT	1	N/A
DEFEB-DA (DECbridge 520) U.S. version, FDDI to 802.3 LAN bridge DAS, standard FDDI optics, one 802.3 port (added)	DEFEB-DA	1	N/A
DEFEB-DB (DECbridge 520) LAN bridge, Non-U.S. version, FDDI to 802.3 DAS, standard FDDI optics ports A and B, one 802.3 port (added)	DEFEB-DB	1	N/A
DEFEB-DM (DECbridge 524) U.S. version, FDDI to 802.3 LAN bridge one DAS FDDI station, single-mode optics on port A, multi-mode optics port B, one Ethernet/802.3 port (added)	DEFEB-DM	1	N/A
DEFEB-DN (DECbridge 524) Non-U.S. version, FDDI to 802.3 LAN bridge, one DAS FDDI station, single-mode optics on port A, multi-mode optics port B, one Ethernet/802.3 port (added)	DEFEB-DN	1	N/A
DEFEB-DP (DECbridge 526) U.S. version, FDDI to 802.3 LAN bridge one DAS FDDI station, multi-mode optics on port A, single-mode optics port B, one Ethernet/802.3 port (added)	DEFEB-DP	1	N/A
DEFEB-DQ (DECbridge 526) Non-U.S. version, FDDI to 802.3 LAN bridge, one DAS FDDI station, multi-mode optics on port A, single-mode optics port B, one Ethernet/802.3 port (added)	DEFEB-DQ	1	N/A

INDEX BY DEC PART DESCRIPTION

DEFEB DECbridge 500/600 Series

DESCRIPTION	DEC PART NO.	FIG. NO.	ITEM NO.
DEFEB-DS (DECbridge 528) U.S. version, FDDI to 802.3 LAN bridge DAS, single-mode FDDI optics port A and B (added)	DEFEB-DS	1	N/A
DEFEB-DT (DECbridge 528) Non-U.S. version, FDDI to 802.3 LAN bridge, DAS, single-mode FDDI optics port A and B (added)	DEFEB-DT	1	N/A
DEFEB-LA (DECbridge 620) U.S. version, FDDI to 3 port 802.3 LAN bridge, DAS, standard FDDI optics	DEFEB-LA	2	N/A
DEFEB-LB (DECbridge 620) Non-U.S. version, FDDI to 3 port 802.3 LAN bridge, DAS, Standard FDDI optics	DEFEB-LB	2	N/A
DEFEB-LM (DECbridge 624) U.S. version, FDDI to 802.3 LAN bridge one DAS FDDI station, single-mode optics on port A, multi-mode optics port B, three Ethernet/802.3 port	DEFEB-LM	2	N/A
DEFEB-LN (DECbridge 624) Non-U.S. version, FDDI to 802.3 LAN bridge, one DAS FDDI station, single-mode optics on port A, multi-mode optics port B, three Ethernet/802.3 port	DEFEB-LN	2	N/A
DEFEB-LP (DECbridge 626) U.S. version, FDDI to 802.3 LAN bridge one DAS FDDI station, multi-mode optics on port A, single-mode optics port B, three Ethernet/802.3 port	DEFEB-LP	2	N/A
DEFEB-LQ (DECbridge 626) Non-U.S. version, FDDI to 802.3 LAN bridge, one DAS FDDI station, multi-mode optics on port A, single-mode optics port B, three Ethernet/802.3 port	DEFEB-LQ	2	N/A
DEFEB-LS (DECbridge 628) U.S. version, FDDI to 3 port 802.3 LAN bridge, DAS, single-mode FDDI optics port A and B	DEFEB-LS	2	N/A
DEFEB-LT (DECbridge 628) Non-U.S. version, FDDI to 3 port 802.3 LAN bridge, DAS, single-mode FDDI optics port A and B	DEFEB-LT	2	N/A
DEFEB-NC (DECbridge 600) U.S. version, 3 port 802.3 LAN bridge	DEFEB-NC	2	N/A
DEFEB-ND (DECbridge 600) Non-U.S. version, FDDI to 3 port 802.3 LAN bridge, SAS, standard FDDI optics	DEFEB-ND	2	N/A
DEFEB-TA (DECbridge 610) U.S. version, FDDI to 3 port 802.3 LAN bridge, SAS, standard FDDI optics	DEFEB-TA	2	N/A

INDEX BY DEC PART DESCRIPTION

DEFEB DECbridge 500/600 Series

DESCRIPTION	DEC PART NO.	FIG. NO.	ITEM NO.
DEFEB-TB (DECbridge 610) Non-U.S. version, FDDI to 3 port 802.3 LAN bridge, SAS, standard FDDI optics	DEFEB-TB	2	N/A
DEFEB-TS (DECbridge 618) U.S. version, FDDI to 3 port 802.3 LAN bridge, SAS, single-mode FDDI optics	DEFEB-TS	2	N/A
DEFEB-TT (DECbridge 618) Non-U.S. version, FDDI to 3 port 802.3 LAN bridge, SAS, single-mode FDDI optics	DEFEB-TT	2	N/A
Enclosure, (Weldment)	70-27395-01	2A	7
Enclosure, (Weldment)	70-27395-01	1A	7
FAN BRACKET ASSEMBLY	70-27394-01	2A	2
FAN BRACKET ASSEMBLY	70-27394-01	1A	2
Fan, 4 1/2 Inch	12-23609-10	2A	2
Fan, 4 1/2 Inch	12-23609-10	1A	2
Fastener, Phl Hd 1/4 Turn	90-10846-01	2A	13
Fastener, Phl Hd 1/4 Turn	90-10846-01	1A	13
Filter, Line EMI 1PH 120V/240V 6/4A	12-32904-01	3	10
Fingerstock, w/D-Lance	12-32618-07	2A	8
Fingerstock, w/D-Lance	12-32618-21	2A	9
Fingerstock, w/D-Lance	12-32618-18	2A	10
Fingerstock, w/D-Lance	12-32618-21	1A	9
Fingerstock, w/D-Lance	12-32618-18	1A	10
Fingerstock, w/D-Lance	12-32618-07	1A	8
Input Assembly, A.C.	70-27416-01	3	6
Insulator, Power Supply	74-39898-01	3	4
Kit, DECbridge 500 to 3-NI ports Upgrade (Contains AP2+, 2 AUI Loopback Connector Assembly, NI3 and Documentation Kit)	DEFEB-UG	1	Not Shown
Kit, SAS to a DAS Upgrade (Contains FI2, 1 FDDI Multi-mode Loopback Connector Assembly, and Documentation Kit)	DEFEB-UP	1	Not Shown
Label, DEFEB "DECbridge 500" Front	36-32533-01	1A	14
Label, DEFEB "DECbridge 500" Rear	36-32050-01	1A	11
Label, DEFEB "DECbridge 600" Front	36-32533-02	2A	14
Label, DEFEB "Option Numbers"	36-35439-01	2A	11
Label, DEFEB "Option Numbers" (added)	36-35439-01	1A	11
Label, DEFEB "Option Numbers" (Ireland)	36-35439-02	2A	11
Label, DEFEB "Option Numbers" (Ireland)	36-35439-02	1A	11
Label, Ground Symbol	36-12680-02	3	7
Module, Application Processor	54-19375-01	1A	6
Module, Application Processor 2	54-19375-02	2A	6
Module, Application Processor 2 (added)	54-19375-02	1A	6
Module, Fiber Interconnect	54-19369-01	2A	4
Module, Fiber Interconnect	54-19369-01	1A	4
Module, Fiber Interconnect DAS ANSI	54-19369-02	2A	4
Module, Fiber Interconnect DAS ANSI (added)	54-19369-02	1A	4
Module, Fiber Interconnect DAS ANSI/SM	54-19369-04	2A	4
Module, Fiber Interconnect DAS ANSI/SM (added)	54-19369-04	1A	4
Module, Fiber Interconnect DAS SM	54-19369-06	2A	4

INDEX BY DEC PART DESCRIPTION

DEFEB DECbridge 500/600 Series

DESCRIPTION	DEC PART NO.	FIG. NO.	ITEM NO.
Module, Fiber Interconnect DAS SM (added)	54-19369-06	1A	4
Module, Fiber Interconnect DAS SM/ANSI	54-19369-05	2A	4
Module, Fiber Interconnect DAS SM/ANSI (added)	54-19369-05	1A	4
Module, Fiber Interconnect Null	54-19369-09	2A	4
Module, Fiber Interconnect SAS SM	54-19369-03	2A	4
Module, Fiber Interconnect SAS SM (added)	54-19369-03	1A	4
Module, Multiport NI	54-19409-01	2A	5
Module, Network Interconnect	54-19373-01	1A	5
Module, Queue Manager	54-19371-01	2A	3
Module, Queue Manager	54-19371-01	1A	3
Nut, Kep No. 10-32 x 3/8	90-06565-00	3	9
Power Cord, Terminal 125V	17-00606-02	1	Not Shown
Power Cord, Terminal 125V	17-00606-02	2	Not Shown
Power Supply, Switching 370W	30-32524-01	3	5
Retainer, Clip-On U-Nut No. 10-32	90-07786-00	2	Not Shown
Retainer, Clip-On U-Nut No. 10-32	90-07786-00	1	Not Shown
Screw, Machine Flat Hd No. 6-32 x 5/16	90-08404-02	2	3
Screw, Machine Flat Hd No. 6-32 x 5/16	90-08404-02	1	3
Screw, Machine Phl Flat Hd No. 6-32 x 5/16	90-08404-02	3	11
Screw, Self-Tap Truss Hd No. 10 x 1/2	90-00063-39	1	Not Shown
Screw, Self-Tap Truss Hd No. 10 x 1/2	90-00063-39	2	Not Shown
Screw, Self-Tap Truss Hd No. 6 x 5/8	90-00062-16	1A	2
Screw, Self-Tap Truss Hd No. 6 x 5/8	90-00062-16	2A	2
Screw, Self-Tap Truss Hd No. 6-32 x 3/8	90-00063-11	3	13
Spring, Retaining	12-12972-13	2A	12
Spring, Retaining	12-12972-13	1A	12
Stiffener, Backplane	74-39892-01	3	3
Washer, Flat	90-06664-00	3	8

READER'S COMMENTS

DEFEB DECbridge 500/600 Series
Illustrated Parts Breakdown
EK-DEFEB-IP-002

1. How did you use this manual? (Circle your response.)

- (a) Installation (c) Maintenance (e) Training
(b) Operation/Use (d) Programming (f) Other (Please specify) _____

2. Did the manual meet your needs? Yes ☐ No ☐ Why? _____

3. Please rate the manual on the following categories. (Circle your response.)

	Excellent	Good	Fair	Poor	Unacceptable
Accuracy	5	4	3	2	1
Clarity	5	4	3	2	1
Completeness	5	4	3	2	1
Illustrations, examples	5	4	3	2	1
Overall ease of use	5	4	3	2	1
Table of Content, Index	5	4	3	2	1

4. What things did you like *most* about this manual? _____

5. What things did you like *least* about this manual? _____

6. Please list and describe any errors you found in the manual.

Page	Description/Location of Error
_____	_____
_____	_____
_____	_____
_____	_____

7. Which of the following most clearly describes your job ? (Circle your response.)

- (a) Administrative Support (e) System Manager (i) Education/Trainer
(b) Manager/Supervisor (f) Computer Operator (j) Sales/Marketing
(c) Scientist/Engineer (g) Software Support (k) Other (Please specify) _____
(d) Programmer/Analyst (h) Hardware Support

OPTIONAL INFORMATION

Name _____ Job Title _____
Street _____ Company _____
City _____ Department _____
State/Country _____ Telephone Number _____
Postal (ZIP) Code _____ Date _____

THANK YOU FOR YOUR COMMENTS AND SUGGESTIONS.

Please do not use this form to order manuals. Contact your representative at Digital Equipment Corporation or (in the USA) call our DECdirect™ department at this toll-free number : 800-258-1710